

City of Hilshire Village

Pine Chase Grove

QUOTE SHEET

ITEM	EST.		DESCRIPTION OF ITEM AND UNIT PRICES		
NO.	QUAN.	UNIT	(IN WORDS AND NUMERALS)	UNIT PRICE	TOTAL AMOUNT
1	200	CY	Installation of rubbermulch, complete in place the sum of:		
2	200	LF	Cut, Grade or re-grade swale, complete in place the sum of:		
3	1	LS	Installation of landscaping, complete in place the sum of:		
4	50	LF	Excavate and backfill trench for conduit, complete in place the sum of:		
5	2	EA	Adjust existing water valves to grade, complete in place the sum of:		
6	1	LS	Enclosure for existing water valve and hose bib and abandonment of switch box, complete in place the sum of:		
7	1	LS	Resodding of disturbed areas, complete in place the sum of:		
8	1	LS	Installation of low profile fence in front of backflow preventers, complete in place the sum of:		
				Total	

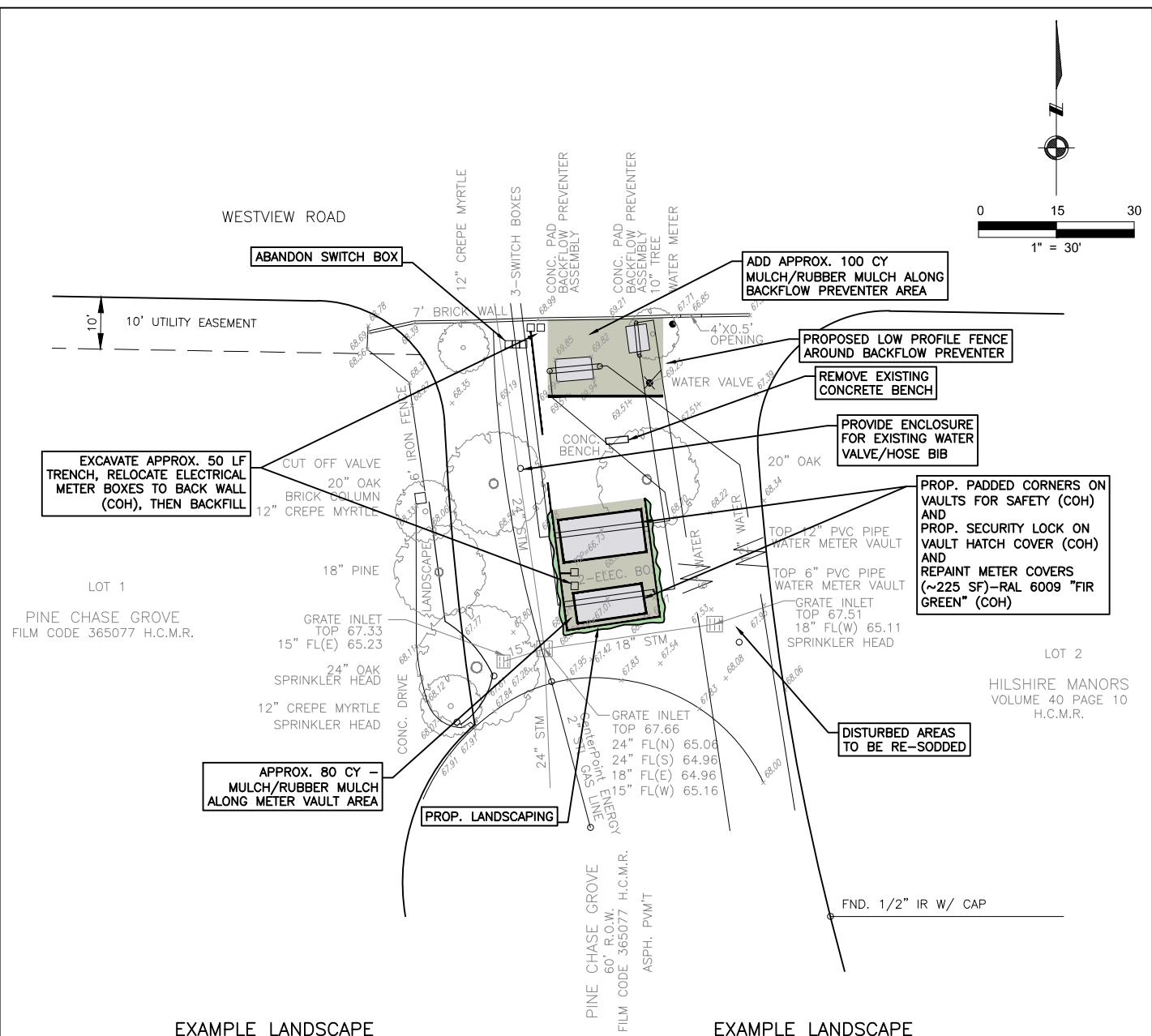
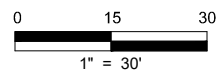

EXAMPLE LANDSCAPE



EXAMPLE LANDSCAPE





Texas P.E. Firm
Registration No. F-754

HDR Engineering, Inc.
4828 Loop Central Drive, Suite 700
Houston, Texas 77081
P 713.922.9064 F 713.922.9065
www.hdrinc.com

City of Hilshire Village, Texas

Pine Chase Grove Project

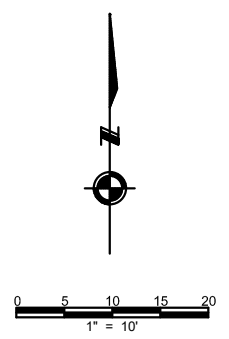
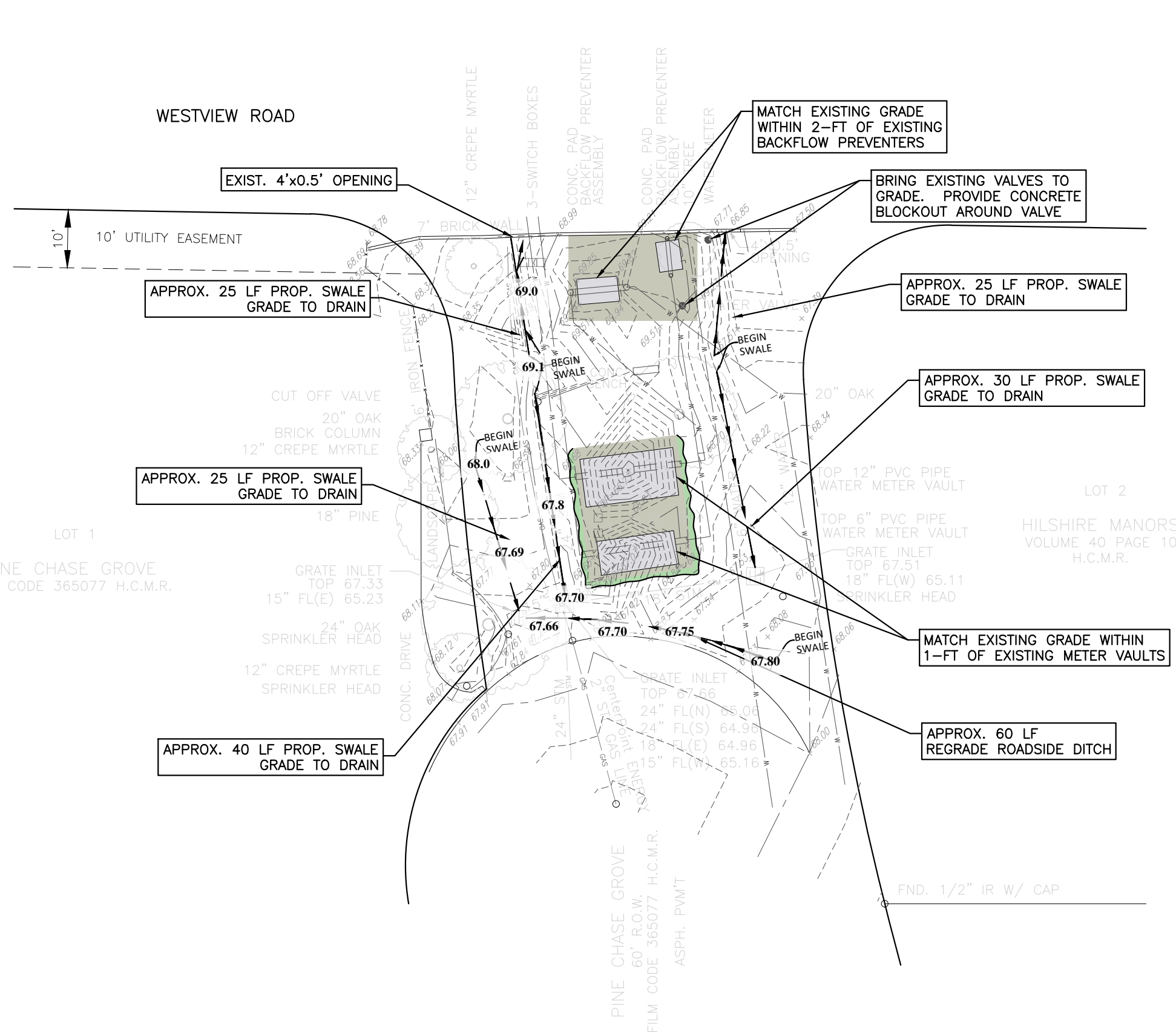
DATE	Dec. 2024
NAME	Exhibit 1



City of Hilshire Village, Texas
Pine Chase Grove Project

DATE	Dec. 2024
NAME	Exhibit 2